

| RUNWAY/TAXIWAY/APRON PHYSICAL CHARACTERISTICS | | |
|---|-------------------|------------|
| RWY / TWY / APRON | SURFACE | PCN |
| RWY 07/25 | Asphalt | 65/F/B/W/T |
| TWY A, B, C, D, E & F | Asphalt | 73/F/C/W/T |
| TWY G | Asphalt | 22/F/C/W/T |
| Apron (All) | See AD 2-EGNT-2-2 | |

| | |
|---|---------------------|
| GUND (Geoid Undulation) = The height of the Geoid (MSL) above the Reference Ellipsoid (WGS 84) at the stated position. | |
| BEARINGS ARE MAGNETIC ELEVATIONS AND HEIGHTS ARE IN FEET | |
| ELEVATIONS IN FEET AMSL | 388 (122) |
| HEIGHTS IN FEET ABOVE AD | |

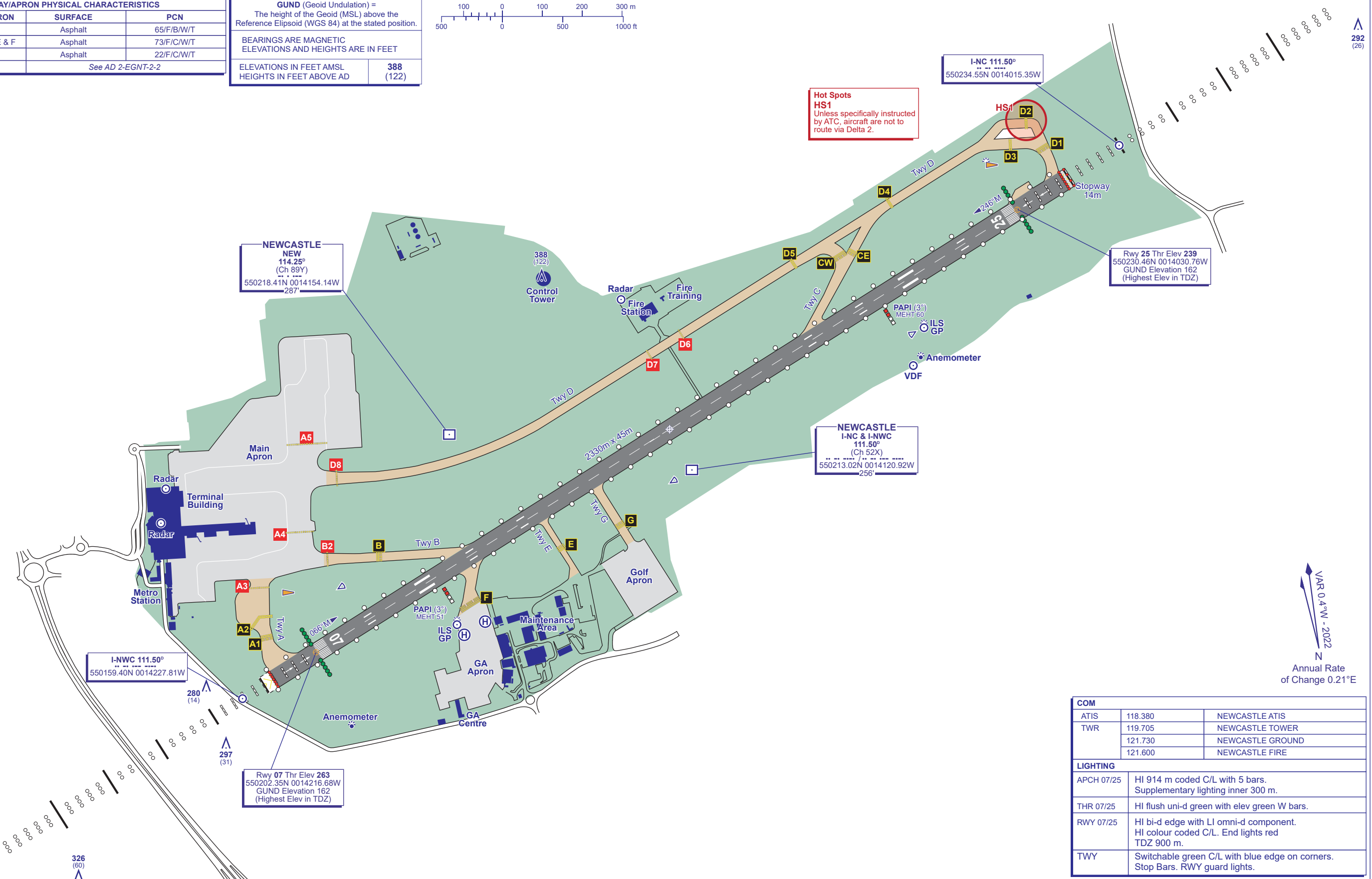
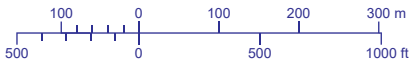

VAR 0.4°W - 2022
N
Annual Rate
of Change 0.21°E

| COM | | |
|------------|---|------------------|
| ATIS | 118.380 | NEWCASTLE ATIS |
| TWR | 119.705 | NEWCASTLE TOWER |
| | 121.730 | NEWCASTLE GROUND |
| | 121.600 | NEWCASTLE FIRE |
| LIGHTING | | |
| APCH 07/25 | HI 914 m coded C/L with 5 bars. Supplementary lighting inner 300 m. | |
| THR 07/25 | HI flush uni-d green with elev green W bars. | |
| RWY 07/25 | HI bi-d edge with LI omni-d component. HI colour coded C/L. End lights red TDZ 900 m. | |
| TWY | Switchable green C/L with blue edge on corners. Stop Bars. RWY guard lights. | |